

Early Vancouver

Volume One

By: Major J.S. Matthews, V.D.

2011 Edition (Originally Published 1932)

Narrative of Pioneers of Vancouver, BC Collected During 1931-1932.

*A Collection of Historical Data, Maps, and Plans Made with the Assistance of
Pioneers of Vancouver Between March and December 1931.*

About the 2011 Edition

The 2011 edition is a transcription of the original work collected and published by Major Matthews. Handwritten marginalia and corrections Matthews made to his text over the years have been incorporated and some typographical errors have been corrected, but no other editorial work has been undertaken. The edition and its online presentation was produced by the City of Vancouver Archives to celebrate the 125th anniversary of the City's founding. The project was made possible by funding from the Vancouver Historical Society.

Copyright Statement

© 2011 City of Vancouver. Any or all of *Early Vancouver* may be used without restriction as to the nature or purpose of the use, even if that use is for commercial purposes. You may copy, distribute, adapt and transmit the work. It is required that a link or attribution be made to the City of Vancouver.

Reproductions

High resolution versions of any graphic items in *Early Vancouver* are available. A fee may apply.

Citing Information

When referencing the 2011 edition of *Early Vancouver*, please cite the page number that appears at the bottom of the page in the PDF version only, not the page number indicated by your PDF reader. Here are samples of how to cite this source:

Footnote or Endnote Reference:

Major James Skitt Matthews, *Early Vancouver*, Vol. 1 (Vancouver: City of Vancouver, 2011), 33.

Bibliographic Entry:

Matthews, Major James Skitt. *Early Vancouver*, Vol. 1. Vancouver: City of Vancouver, 2011.

Contact Information

City of Vancouver Archives
1150 Chestnut Street, Vancouver, B.C. V6J 3J9
604.736.8561
archives@vancouver.ca
vancouver.ca/archives



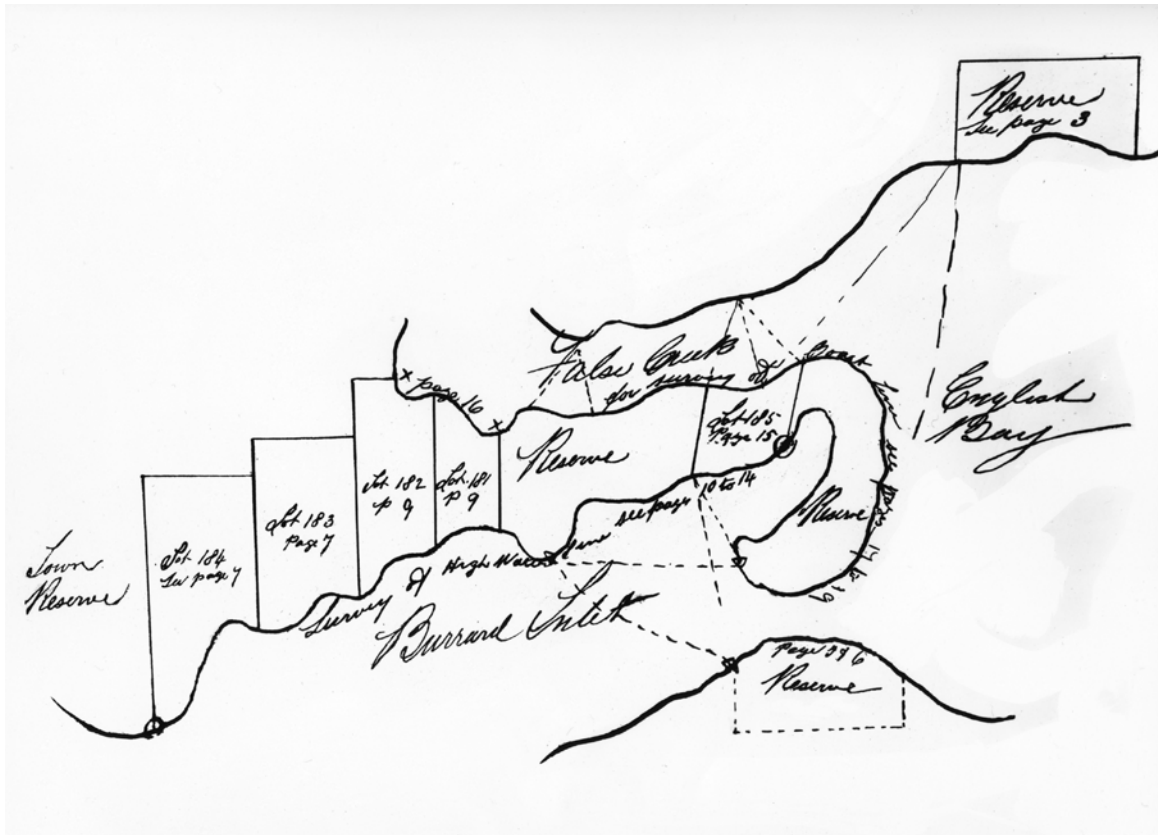

Item # EarlyVan_v1_0092

3 JANUARY 1932 - BURRARD INLET SURVEY, 1863. SURVEY OF SITE OF VANCOUVER. ROYAL ENGINEERS.

There was delivered to the Land Registry office, Vancouver, during the month of December 1931, a remarkably interesting document: a small, inexpensive notebook, about eight inches square, and which, according to an official of the office, had just been handed to them by R.L. Reid, Esq., K.C., who told them he had found it amongst his papers, but did not know how it got there. The official told me that they had long been unable to determine certain matters (shoreline southeast of C.P.R. roundhouse) in connection with the topography of Vancouver, but which were now clear to them.

The first page explains itself. It is a letter written on an ordinary piece of white paper as follows:

26 Jan'y 1863

Copied

Copy handed to
Corp'l Turner.
W. McColl, S.R.E.

Memo for Capt. Parsons RE

I wish Corporal Turner and party to proceed by earliest opportunity to Burrard Inlet to revise posts of gov't reserve for town near entrance—Do. Do. naval reserve and then to survey lands the property of R. Burnaby and N.P.P. Crease and from thence to lay out claims or survey lands (160 acres each, narrow side to shore front) between such points and the village which has been laid out "en

bloc." In laying out above the party is especially to mark on plan and transmit the same as early as possible to me showing any clearances or huts or other "occupations" recently made by any parties.

R.C.M. (Col. R.C. Moody, R.E.)

Col. Com'g

Then follow many pages of original survey notes of Burrard Inlet, sketches, drawings and distances made in February 1863 by Corporal Turner, showing in detail shores, rivers, creeks and huts, etc.

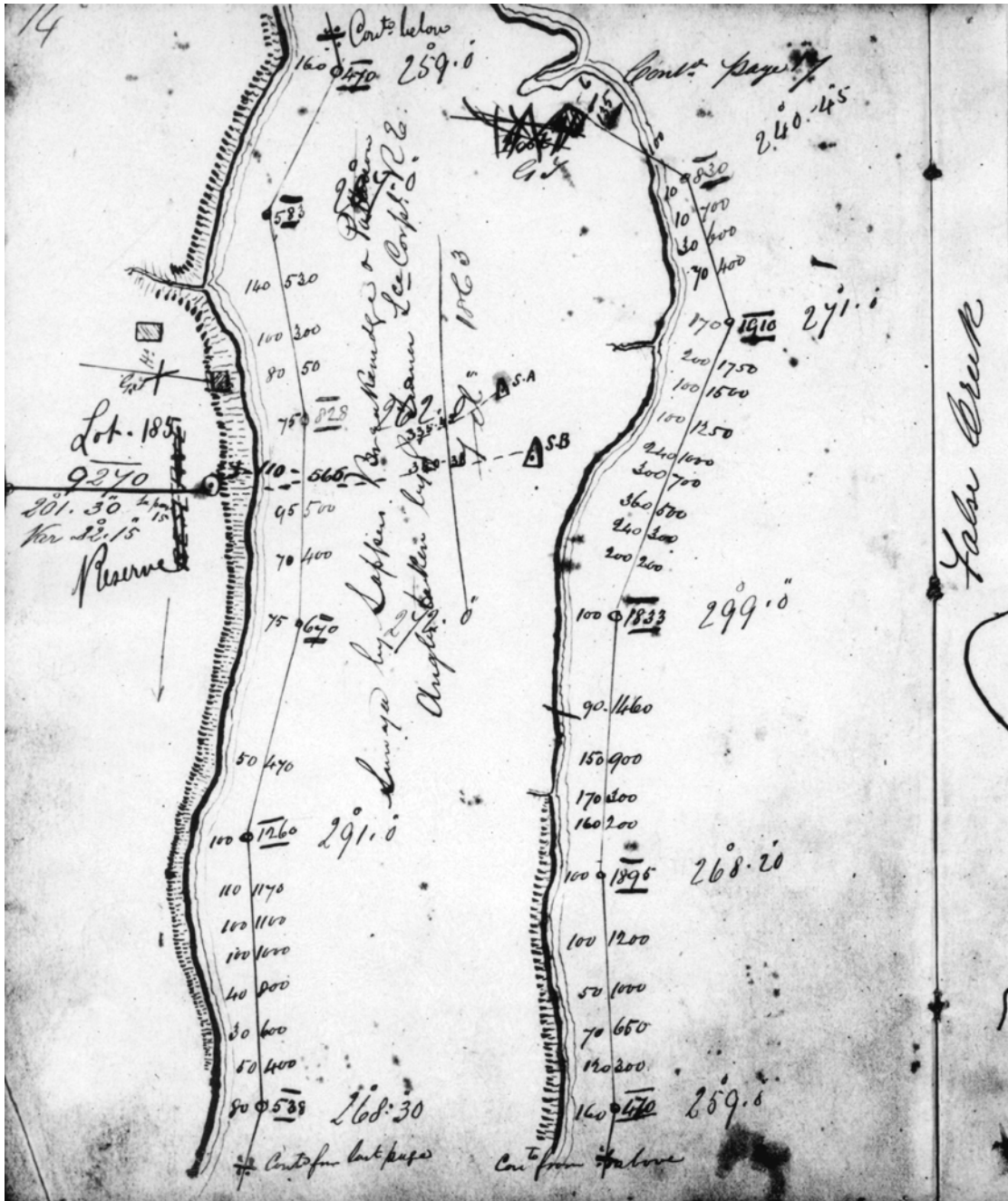

Item # EarlyVan_v1_0093

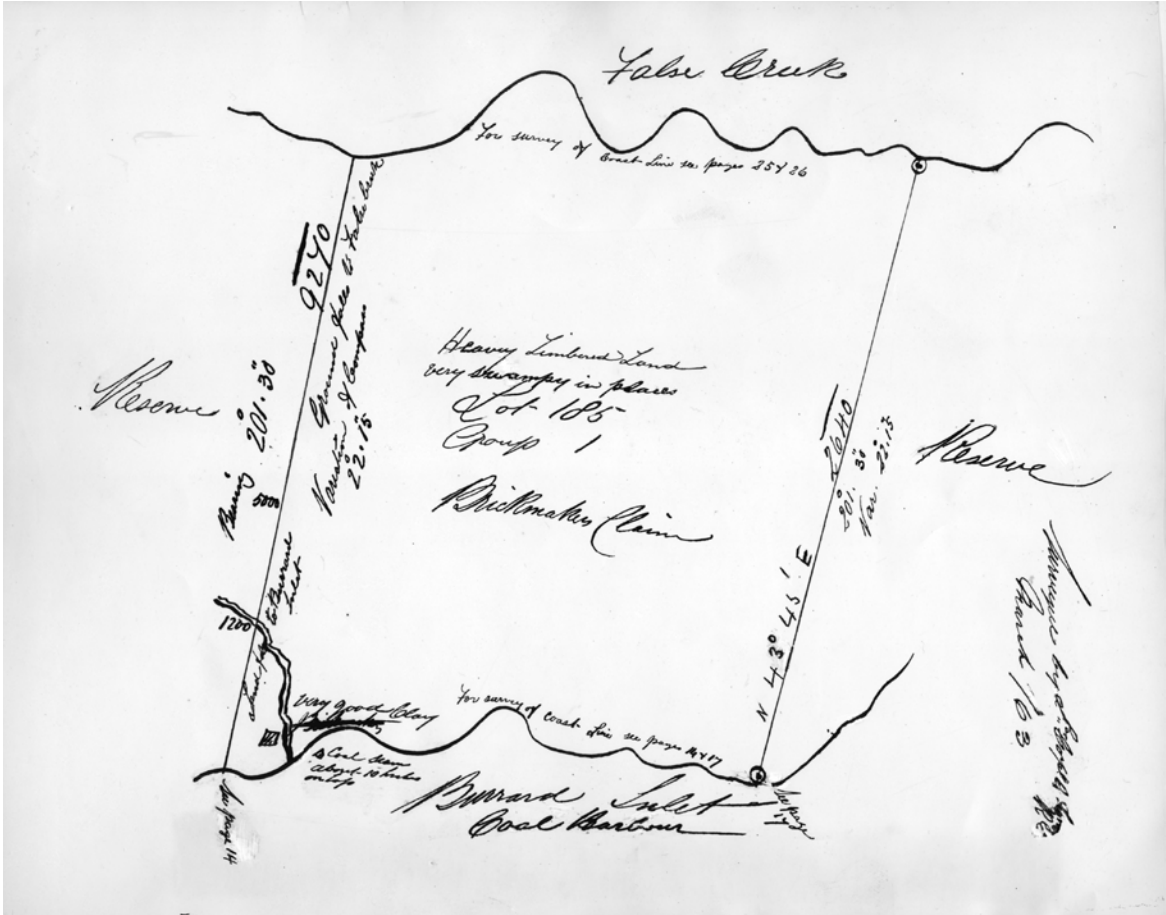

Item # EarlyVan_v1_0094